

These quality-produced tube and pipe fittings are designed for use with LUBRIQUIP[®] lubricating systems. All dimensions are in inches. For millimeter equivalents, convert fraction to a decimal and multiply by 25.4.

STEEL PIPE FITTINGS

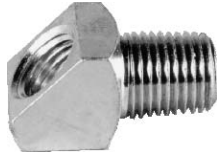

45° Street Elbows - Steel **Order Part No.**
 1/8 female, 1/8 male threads 509-111-000
 1/4 female, 1/4 male threads 509-114-000



90° Street Elbows - Steel
 1/8 female, 1/8 male threads 509-110-000
 1/4 female, 1/8 male threads 509-112-000
 1/4 female, 1/4 male threads 509-113-000
 1/8 female, 1/4 male threads 509-115-001
 1/4 female, 3/8 male threads 509-116-000
 3/8 female, 3/8 male threads 509-117-000

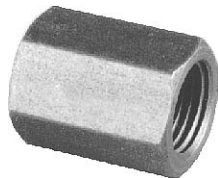

Hexagon Coupling - Steel
 1/8 pipe thread 509-026-000



Reducing Bushing - Steel
 1/4 male, 1/8 female threads 412-170-010



Reducing Adapter - Steel
 1/4 female, 1/8 male pipe 412-330-200

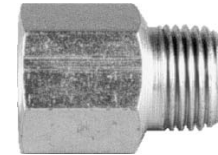

1/8 Thread Pipe Extension Nipples - Steel
 3/4 overall length 509-027-000
 1-1/4 overall length 509-028-000
 2-1/4 overall length 509-020-000



Hex Shoulder Nipples - Steel
 Straight, 1/4 x 1/4 threads 412-230-020
 Reducing, 1/4 x 1/8 threads 412-230-030

2-PIECE FLARED TUBE FITTINGS

For use only with copper and steel tubing. Order tube nuts and elbows separately.



Male Elbows (37° Flare) - Steel **Order Part No.**
 1/4 tube size, 1/4 pipe thread 441-080-030
 3/8 tube size, 1/4 pipe thread 441-080-050



Tube Nuts - Brass
 1/4 tube size 441-060-020
 3/8 tube size 441-060-030

3 - PIECE COMPRESSION TUBE FITTINGS

For use with copper and nylon tubing. Furnished with nut and sleeve.

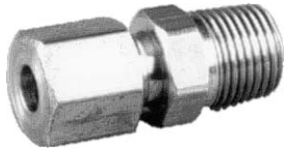

- | | |
|---------------------------------------|-----------------------|
| Male Connectors - Brass | Order Part No. |
| 3/16 tube size, 1/8 pipe thread | 435-360-010 |
| 1/4 tube size, 1/8 pipe thread | 435-360-020 |
| 1/4 tube size, 1/4 pipe thread | 435-360-030 |

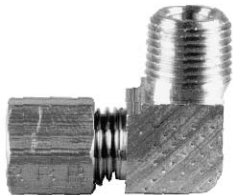

- | | |
|---------------------------------------|-------------|
| Male Elbows - Brass | |
| 3/16 tube size, 1/8 pipe thread | 435-370-010 |
| 1/4 tube size, 1/8 pipe thread | 435-370-020 |
| 1/4 tube size, 1/4 pipe thread | 435-370-030 |



- | | |
|-------------------------------|-------------|
| Straight Union - Brass | |
| 3/16 tube size | 435-700-230 |



- | | |
|------------------------------|-------------|
| Spare Sleeves - Brass | |
| 3/16 tube size | 435-380-010 |
| 1/4 tube size | 435-380-020 |

3 - PIECE FLARED TUBE FITTINGS

For use only with copper and steel tubing. Furnished with nuts and sleeves.

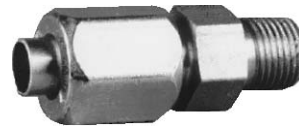

- | | |
|--------------------------------------|-----------------------|
| Male Connector - Steel | Order Part No. |
| 1/4 tube size, 1/8 pipe thread | 441-010-030 |

Look to LUBRIQUIP, Inc.
for all of your
Centralized Lubrication System needs.

Products include:

DIVIDER VALVES: for oil and grease...to 7,500 PSI...
 1 to 24 points from a single valve assembly...up to 256
 points from a Master/Secondaries circuit...or systems
 that handle an entire plant.

PUMPS: fixed and variable displacement...manual and
 air, hydraulic, electric motor or mechanically driven.

TIMERS/AUTOMATIC CONTROLS: from simple on/off
 to complete flow and pressure monitoring, either time-
 or machine-actuated.

ACCESSORY VALVES: balancing, check and flow.

INDICATORS: performance and broken line.

ACCESSORIES: fittings, brackets, clamps, filters and
 strainers.

ISO 9000:2000
 REGISTERED FIRM

ISO 14001
 REGISTERED FIRM