

Gerotor pumps for clockwise or counterclockwise rotation, but with constant direction of rotation and delivery

Gerotor pumps are distinguished by quiet running and little pulsation. They have an internally geared delivery element (trochoid gearing).

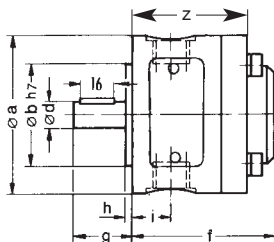

143-011-131



S = inlet (suction port)
P = outlet (pressure port)

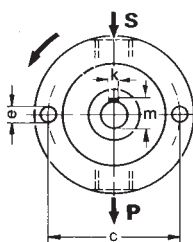

Type X
Direction of rotation:
counterclockwise

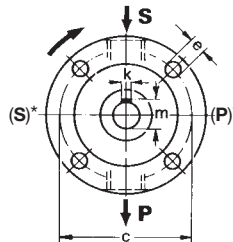

Type Y
clockwise
*) with model 143-011-500

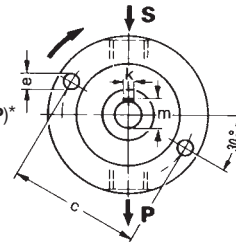

Type Z
clockwise

Order No.	Max. delivery rate at 1400 rpm [l/min]	Max. back pressure [bars]	Required drive power at back pressure		Suction and pressure port		Suction head ¹⁾ [mm]	Suction Rotation	Dimensions [mm]											
			[kW]	[bars]	Type	Dimension			Dimension	Dimension	Dimension	Dimension	Dimension	Dimension	Dimension	Dimension	Dimension			
143-011-131	0.85 1.7 ²⁾	30	0.18 0.37	30 30	G 1/4	Z	1000	right	60	36	48	8 _{h5}	6.6	49	25	3	12.5	2	8.8	40
143-011-151	2.5	50	0.18/0.37	20/50	G 3/8	X	1000	left	74	45	56	12 _{h6}	6.6	62	28	3	17	4	13.5	50
143-011-161	5.25	50	0.37/0.75	20/50	G 1/2									69			18.5			60
143-011-171	9	50	0.55/1.1	20/50	G 1/2	Y	1000	right	88	56	70	14 _{h6}	6.6	77	30	3	20	5	16	67
143-011-181-2	12.5	50	0.75/1.5	20/50	G 3/4									93			22			79
143-011-500	19	20	1.5	20	G 1	Y	1000	right	98	56	80	16 _{g5}	8.5	100	30	3	25	5	18	100

¹⁾ with open delivery line at 1400 rpm

²⁾ at 2800 rpm

Order adapters with ports tapped for solderless tube connection separately.

**Gerotor pump for clockwise and counterclockwise rotation,
but for constant direction of delivery with changing direction of drive shaft rotation to DIN 69001, Part 17 A**

This pump is especially suitable for direct gear drive.

When the pump is used in systems that do not have an open delivery line, e.g. which have a check valve, safety valve or closed bearings, it is necessary to provide for a venting aid.

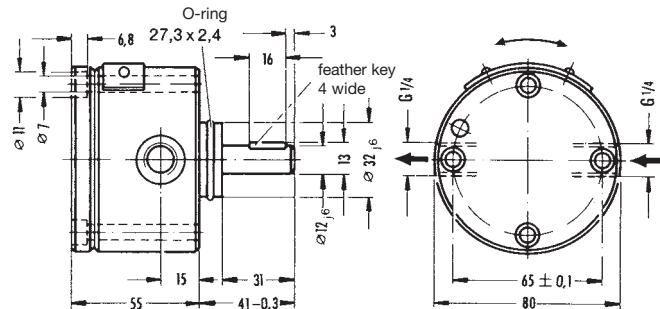

Order No.	Delivery rate ³⁾ per revolution [ccm]	Speed range [rpm]	Max. back pressure [bars]	Suction head ⁴⁾ [mm]	Direction of rotation
143-011-560	4	200-2000	20	1000	any

³⁾ Corresponds to 5.4 l/min at 1400 rpm as related to an operating viscosity of 140 mm²/s at a back pressure of 1 bar.

⁴⁾ with open delivery line